

# Insulating needles with piercing aid

Ideally suited for unerring filling and compaction



## Insulating needles with piercing aid

- ▶ Good ergonomics, as no climbing steps required
- ▶ Rigid design facilitates re-compaction, distant corners easily accessible thanks to bend
- ▶ Excellent sealing due to smooth surface

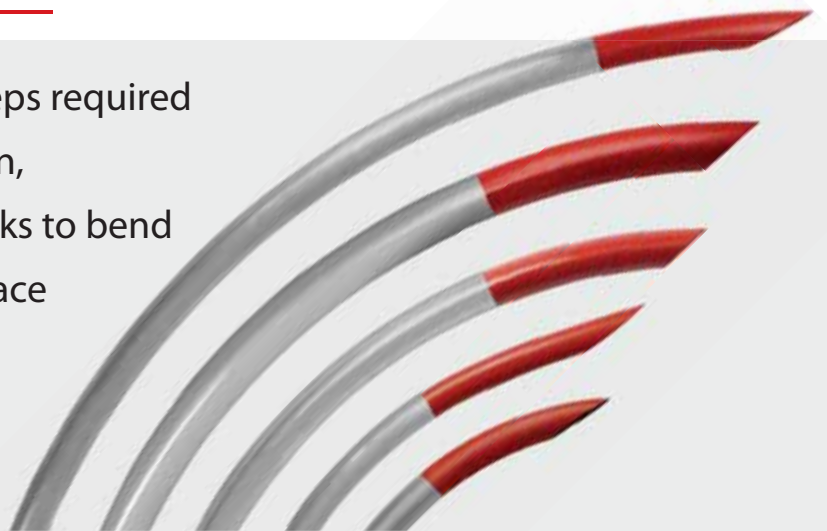

# X-Floc Insulating needles

## Insulating needles with piercing aid

Accurate filling and compacting: X-Floc insulating needles are primarily bent aluminium tubes for precise insertion of insulation material, for re-compacting insulation layers and buffer insulation as well as for blowing in slots as well as hard-boarded compartments with a sufficiently large blow-in opening. The specially shaped pipe tip facilitates the piercing of foils and boards. For blowing in horizontal elements and e.g. for blowing in roof slopes (from the unfinished attic), the blowing needles are also available in a straight version.

### Advantages at a glance

- ▶ Good ergonomics, as climbing steps are not necessary
- ▶ Low weight due to thin-walled aluminium tube
- ▶ By means of bending, even distant corners can be easily reached
- ▶ Smooth surface ensures easy sealing and avoidance of insulation residues when pulling out the needle
- ▶ Specially shaped tube tip with colour marking for easy piercing and shifting resp. directing the material flow

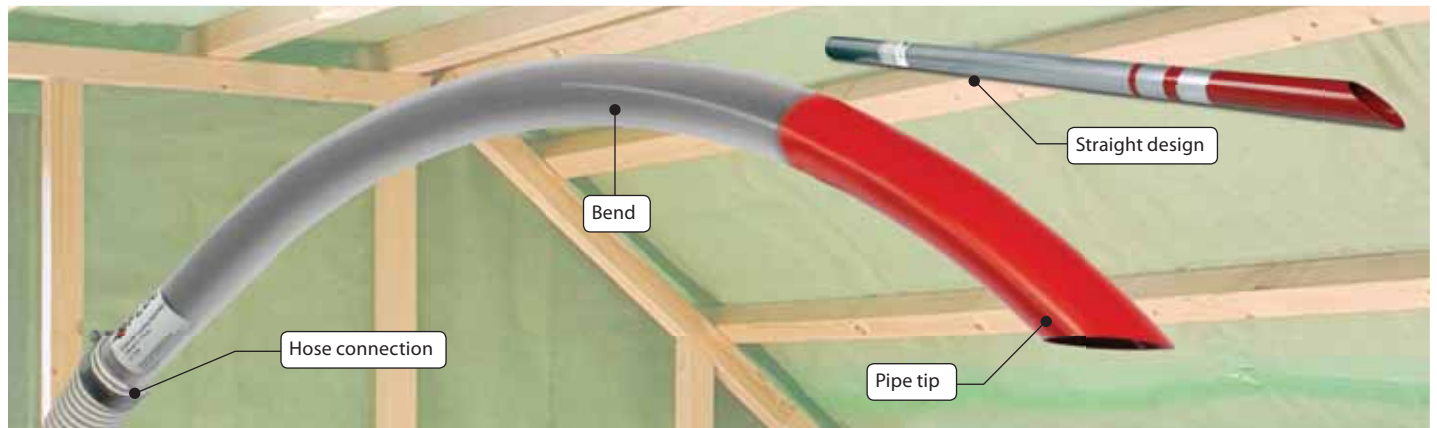

## Filling concept

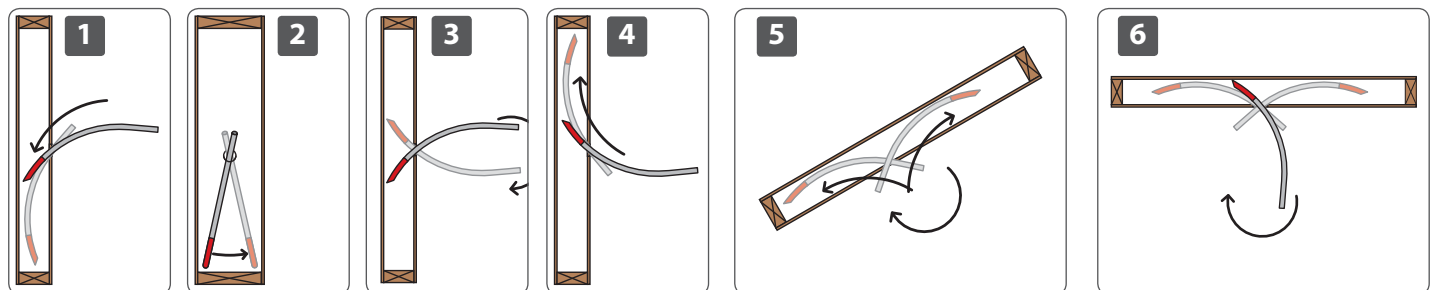

Example: Stud wall

Insert the insulating needle (1), swivel (2), pull out and turn upwards (3) Fill upper area by swivelling (4)

Example: Roof pitch (5) and ceiling (6)

Blow-in starting at the lower end of the rafter

Insulating needle	Min. insulation thickness $S_D$	Hose connection $\phi$	Injection port	Total length L	Art. no.
NW50-100	approx. 100mm	NW50 (2")	$\phi$ 120mm	ca. 100cm	6180
NW38-130	approx. 120mm	NW38 (1½")	$\phi$ 120mm	ca. 130cm	5304
NW50-140	approx. 170mm	NW50 (2")	$\phi$ 120mm	ca. 140cm	5303
NW63-140	approx. 230mm	NW63 (2½")	$\phi$ 120mm	ca. 140cm	5836
NW75-140	approx. 310mm	NW75 (3")	$\phi$ 120mm	ca. 140cm	6710
NW50-180	approx. 200mm	NW50 (2")	$\phi$ 120mm	ca. 180cm	5153
NW63-180	approx. 270mm	NW63 (2½")	$\phi$ 120mm	ca. 180cm	6390
NW75-180	approx. 340mm	NW75 (3")	$\phi$ 120mm	ca. 180cm	6711
NW38-straight	all insulation thicknesses	NW38 (1½")	$\phi$ >38mm	up to 600cm* Standard length: 300cm	6028
NW50-straight		NW50 (2")	$\phi$ >50mm		5730
NW63-straight		NW63 (2½")	$\phi$ >63mm		5839
NW75-straight		NW75 (3")	$\phi$ >75mm		5840

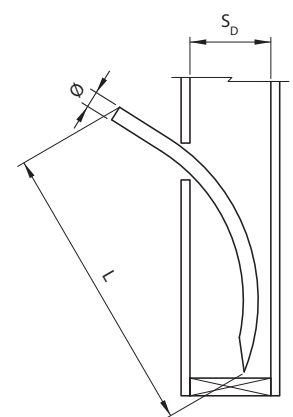

\* Specify desired length when ordering.

# X-Floc Insulating needles

## Comparison insulating needles

► Insulating needle NW50-100  
Art. no. 6180

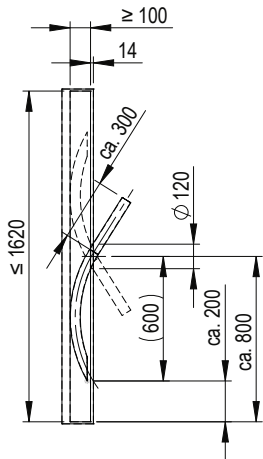

► Insulating needle NW38-130  
Art. no. 5340

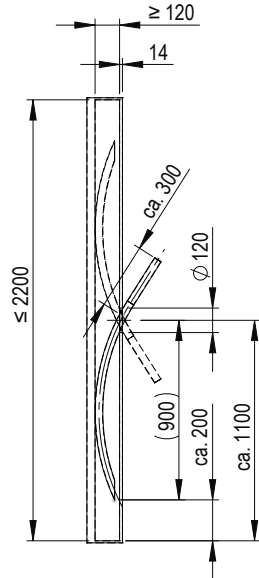

► Insulating needle NW50-140  
Art. no. 5303

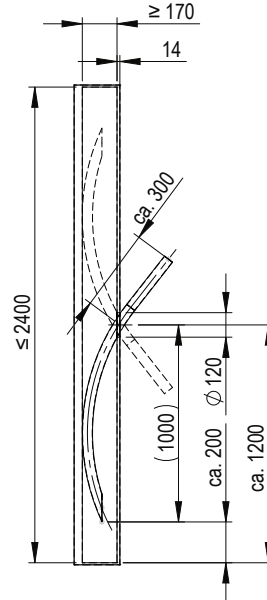

► Insulating needle NW63-140  
Art. no. 5836

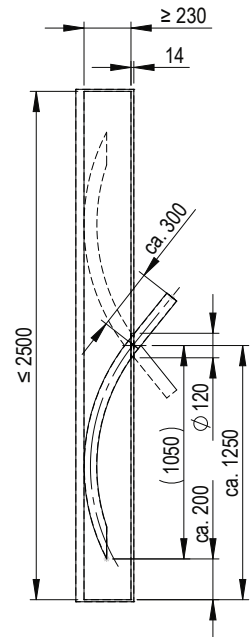

► Insulating needle NW75-140  
Art. no. 6710

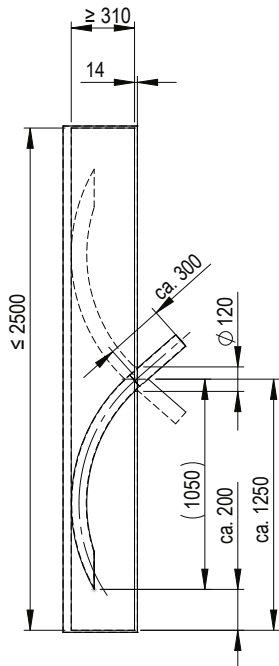

► Insulating needle NW50-180  
Art. no. 5153

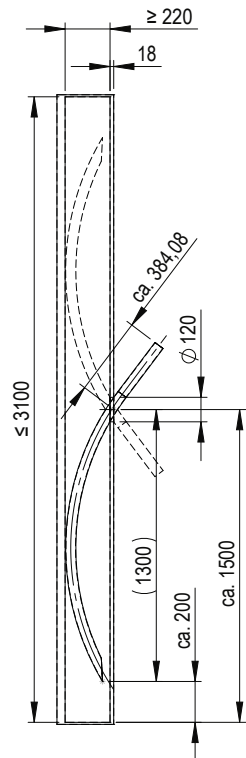

► Insulating needle NW63-180  
Art. no. 6390

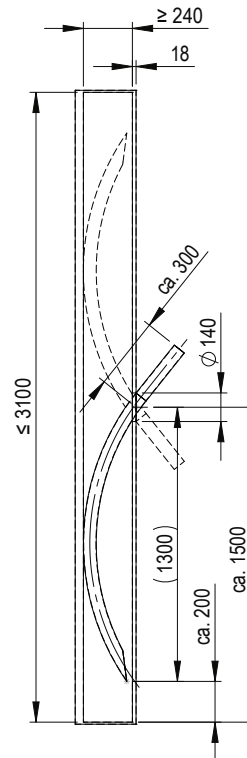

► Insulating needle NW75-180  
Art. no. 6711

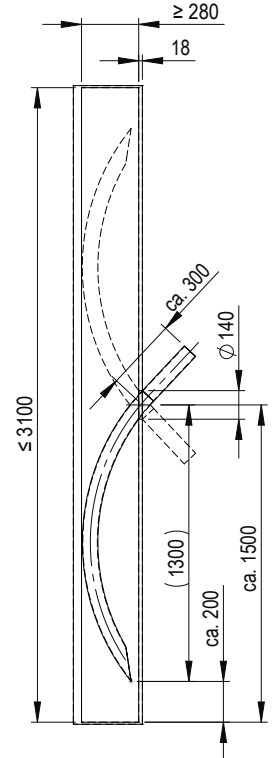

The specifications correspond to the minimum insulation thicknesses for fixed planking with 120mm drill hole. With foils or long holes (e.g. two overlapping holes 106.5 mm = approx. 170 mm), the needles can already be used with lower insulation thicknesses.

For optimal handling of the insulating needles, we recommend the matching connection sets and rotatable hose connectors as a supplement.

# X-Floc Insulating needles

## Connection sets and accessories

The matching connection set is the optimal addition for easy handling of the injection needle. Each set contains a 4m long flexible delivery hose, a reducer tube connector, two hose clamps and a sealing sponge.

Also rotatable hose connectors (SDVxx) are available as an option, allowing easy handling of the injection and delivery hoses without creating loops.

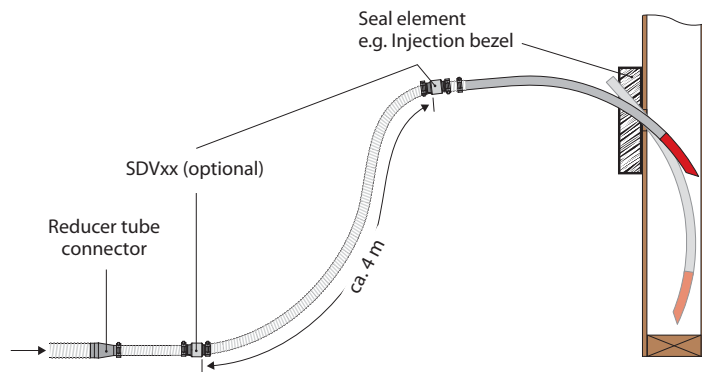

### Recommended injection openings

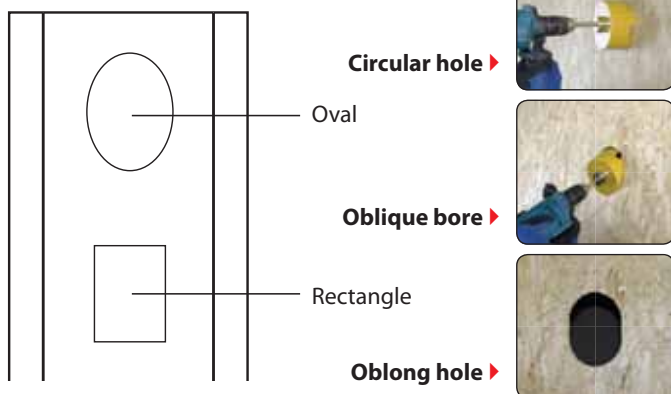

Connection sets	for Art. no.	Art. no.
<b>Set NW75&gt;50</b>	6180, 5303, 5153 5730, 5840	6103
<b>Set NW63&gt;50</b>	6180, 5303, 5153 5730	6206
<b>Set NW63&gt;38</b>	5304, 6028	6104
<b>Set NW75&gt;63</b>	5836, 6390, 5839, 5840	6124
<b>Set NW90&gt;75</b>	6710, 6711	10141

## Hose connector rotatable

Rotary hose connector	for Art. no.	Art. no.
<b>SDV50</b>	6180, 5303, 5153	6522
<b>SDV63</b>	5836, 6390	6896
<b>SDV75</b>	6710, 6711	4451

## Accessories

Accessories	Description	Art. no.
<b>Reducer tube connector</b>	NW75>63	1264
	NW75>50	1262
	NW63>50	1261
	NW63>38	1263
	NW50>38	1970
<b>Sealing sponge</b>	NW50/NW63	7100
	NW38/NW50	7101
	NW63/NW75	7099
<b>Injection bezel universal</b>	ø 30...60mm	8787
	ø 45...70mm	8906
	ø 65...100mm	8907
<b>Hole saw</b>	ø 106,5mm	4966
	ø 120mm	5282
<b>Hole saw Pro</b>	ø 106,5mm	1733
<b>Hole saw HF</b>	ø 106,5mm	9145
<b>Sealing corks</b>	ø 106mm	1948
	ø 120mm	4671
<b>Sealing plugs</b>	ø 109mm	8950
	ø 120mm	8951

Further accessories and detailed information you'll find in the brochure called „Nozzles and Blow-in Accessories“.

### X-Floc Dämmtechnik-Maschinen GmbH

Rosine-Starz-Straße 12 · 71272 Renningen · Germany

Telefon: +49-7159-80470-30 · Fax: -40

E-Mail: info@x-floc.com · www.x-floc.com



Your X-Floc Distributor

**iCell.**  
Klimatsmart isolering

info@icell.se

0251-130100